

NOTES:

1. BALL, STEM, AND HANDLE SHOWN IN CLOSED POSITION

2. VALVE TO BE ASSEMBLED WITHOUT OIL, GREASE, OR SILICON

LEGEND

- REPLACE EVERY REPAIR
- MIN. OF 2 TURNS OR REPLACE IF DAMAGED
- MIN. OF 3 TURNS OR REPLACE IF DAMAGED
- REPLACE ONLY IF DAMAGED

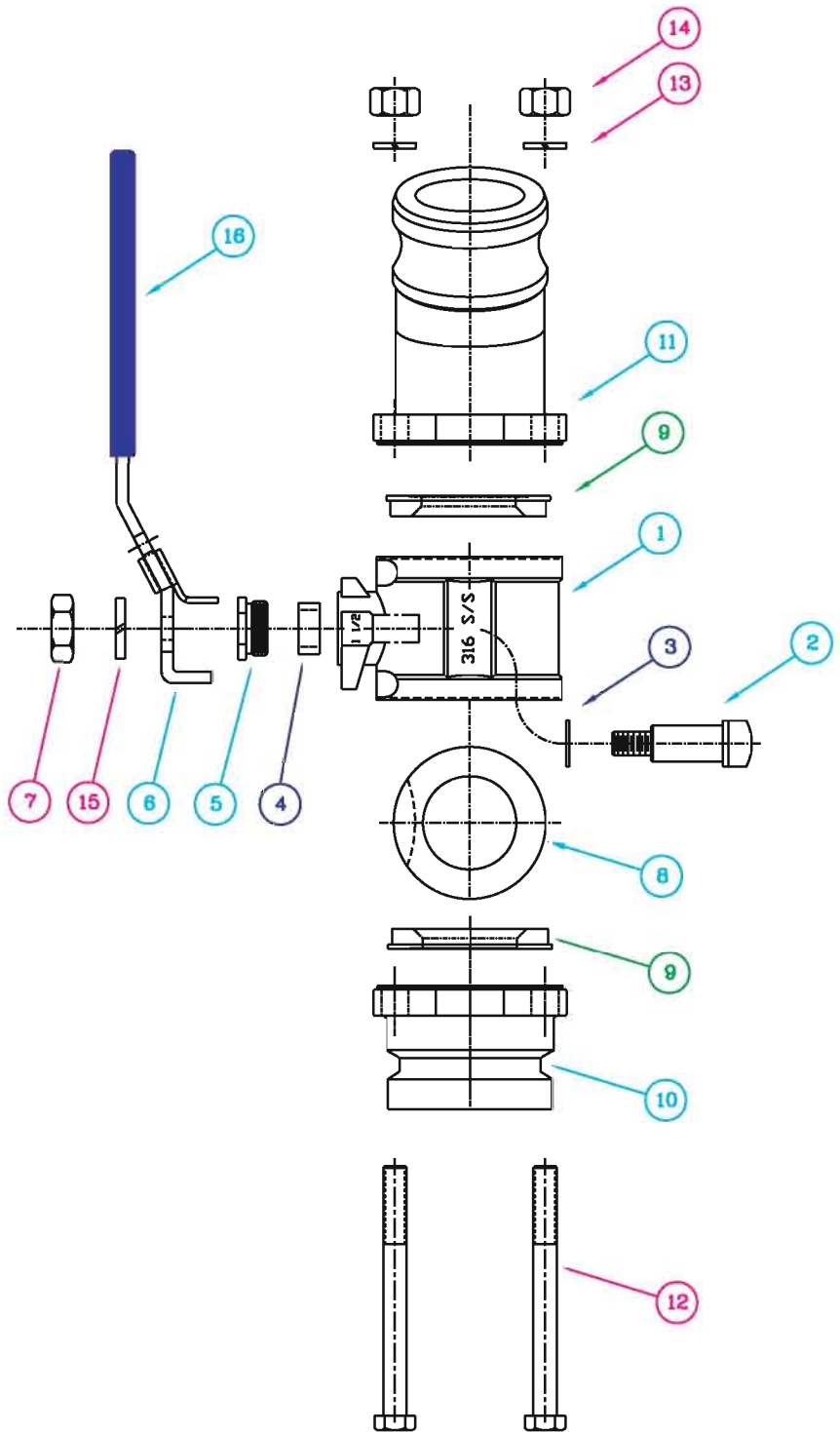

--	G	REDRAWN	28-AUG-2002	SCHULTE	REICH	
ZONE	REV	REVISION DESCRIPTION	DATE	REVISED BY	APPROVED BY	
UNLESS OTHERWISE SPECIFIED DIMENSIONS ARE IN INCHES GENERAL TOLERANCES		PROJECTION DO NOT SCALE THIS DRAWING BREAK ALL SHARP EDGES REMOVE BURRS & FLASH	AMERICAN MACHINING, INC. FENTON, MICHIGAN			
FRACTIONS: ± 1/32	.xx DECIMALS: ± .010	.xxx DECIMALS: ± .005	.xxxx DECIMALS: ± .001	ANGLES: ± 1'	FINISH: N/A ✓	
THIS DRAWING HAS BEEN FURNISHED BY AMERICAN MACHINING, INC. THE INFORMATION AND KNOW-HOW CONTAINED MAY NOT BE USED NOR MAY THE DRAWING BE REPRODUCED WITHOUT THE WRITTEN PERMISSION OF AMERICAN MACHINING, INC. ALL REPRODUCTIONS IN WHOLE OR IN PART, INCLUDING VENDOR SHOP DRAWINGS, SHALL BEAR OR REFER TO THIS NOTE.		SPECIAL FINISH: N/A	DESCRIPTION AMI 1000 W.O.G. 3-PC. BALL VALVE SERVICE PARTS INFORMATION			
		DRAWN BY: M. SCHULTE	28-Aug-02	SIZE: A	PART NUMBER: 111111-SERVICE	REV: G
		CHECKED BY: REICH	28-Aug-02	SCALE: 1/3	MAT'L: N/A	SHEET 1 OF 2
APPROVED BY: <i>B. Reich</i>		DATE: 29-Aug-2002				

SERVICE PARTS LIST

ITEM NO.	PART NO.	DESCRIPTION	QUAN.
1	111170	BODY - VALVE 316 SS	1
2	111168	STEM	1
3	111174	SEAL - STEM, LOWER, TFE	1
4	111167	SEAL - STEM, UPPER, TFE	1
5	113839	GLAND - PACKING, 316 SS	1
6	111166	HANDLE ASSEMBLY - VALVE (Includes sleeve & locking tab)	1
7	111172	NUT - HEX, JAM, 18-8 S/S	1
8	111169	BALL - VALVE, 316 S/S	1
9	110620	SEAT - BALL, TFE	2
10	110642	FITTING - END, 2" I-LINE	1
11	110641	FITTING - END, 2" QD ADAPTER, 15°	1
12	110582	SCREW - HHCS, 18-8 SS	4
13	111171	WASHER - SPLIT LOCK, 18-8 SS	4
14	100002	NUT - HEX, 18-8 SS	4
15	111184	WASHER - SPLIT LOCK 18-8 SS	1
			1

LEGEND

- REPLACE EVERY REPAIR
- MIN. OF 2 TURNS OR REPLACE IF DAMAGED
- MIN. OF 3 TURNS OR REPLACE IF DAMAGED
- REPLACE ONLY IF DAMAGED

--	G	REDRAWN					
ZONE	REV	REVISION	DESCRIPTION	DATE	REVISED BY	APPROVED BY	
UNLESS OTHERWISE SPECIFIED DIMENSIONS ARE IN INCHES GENERAL TOLERANCES		PROJECTION 	DO NOT SCALE THIS DRAWING BREAK ALL SHARP EDGES REMOVE BURRS & FLASH	AMERICAN MACHINING, INC. FENTON, MICHIGAN			
FRACTIONS: ± 1/32 .XX DECIMALS: ± .010 .XXX DECIMALS: ± .005 .XXXX DECIMALS: ± .001 ANGLES: ± 1°	FINISH: N/A ✓ SPECIAL FINISH: N/A		DESCRIPTION AMI 1000 W.O.G. 3-PC. BALL VALVE SERVICE PARTS INFORMATION				
THIS DRAWING HAS BEEN FURNISHED BY AMERICAN MACHINING, INC. THE INFORMATION AND KNOW-HOW CONTAINED MAY NOT BE USED NOR MAY THE DRAWING BE REPRODUCED WITHOUT THE WRITTEN PERMISSION OF AMERICAN MACHINING, INC. ALL REPRODUCTIONS IN WHOLE OR IN PART, INCLUDING VENDOR SHOP DRAWINGS, SHALL BEAR OR REFER TO THIS NOTE.		DRAWN BY: M. SCHULTE CHECKED BY: REICH APPROVED BY: <i>B. Reich</i>	28-Aug-02 28-Aug-02 29-Aug-2002	SIZE A	PART NUMBER 111111-SERVICE	REV G	
		SCALE: 1/3	MAT'L: N/A	SHEET 2 OF 2			